

# CRACKS & CONTROL JOINTS

SEMCO Liquid Membrane™ over cracks wider than 1/4"

CAUTION! Reopen exterior control joints - 1/4" wide and 1/4" deep.

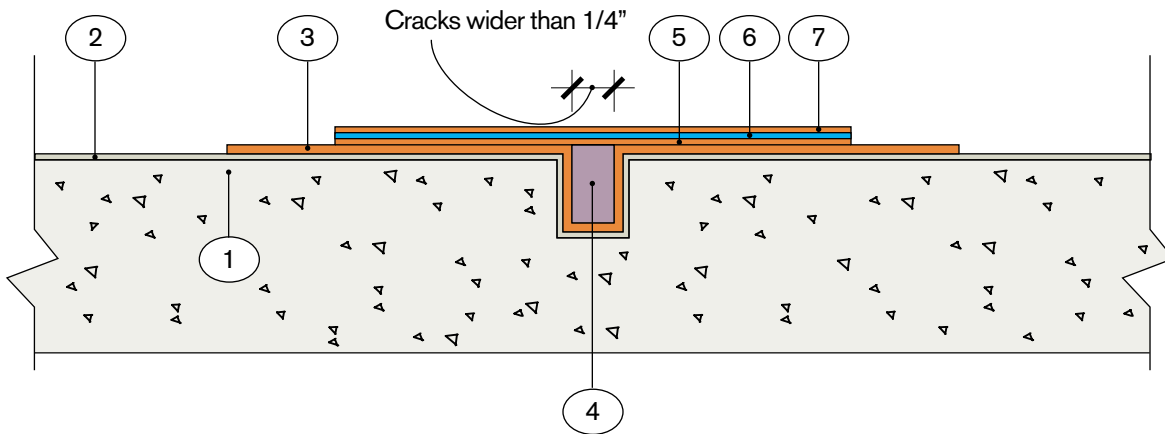

- 1. Existing substrate - concrete
- 2. Scratch Coat
- 3. SEMCO Liquid Membrane™ - apply 2 coats (40 mils)
- 4. Fill cracks with X-Bond Brown Coat:  
1 part of X-Bond Liquid to 1 part of X-Bond Additive to 2 1/2 parts of X-Bond Stone
- 5. SEMCO Liquid Membrane™ - 1st coat
- 6. Fabric reinforcement, while Liquid Membrane is still wet, embed fabric reinforcement into it
- 7. SEMCO Liquid Membrane™ - apply 2nd coat over embedded fabric reinforcement immediately



**FLOORS | WALLS | POOL DECKS | WATERPROOFING**  
REDEFINING THE ART OF SURFACE CREATIVITY FOR OVER 25 YEARS USING GREEN MATERIALS

