

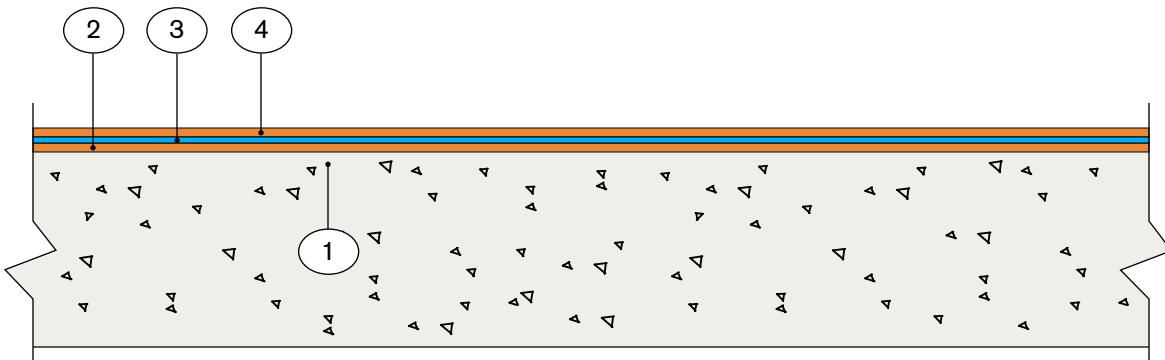

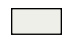

# SEMCO LIQUID MEMBRANE™ DETAIL

SEMCO Liquid Membrane™ over concrete



-  1. Existing substrate - concrete
-  2. SEMCO Liquid Membrane™ - 1 coat at 15 mil
-  3. Fabric reinforcement - while wet, embed fabric reinforcement and apply 15 mil to the fabric applied area (for expansion joints that do not exceed 1/8" joints must be filled prior to bridging)
-  4. SEMCO Liquid Membrane™ - 1 coat at 15 mil

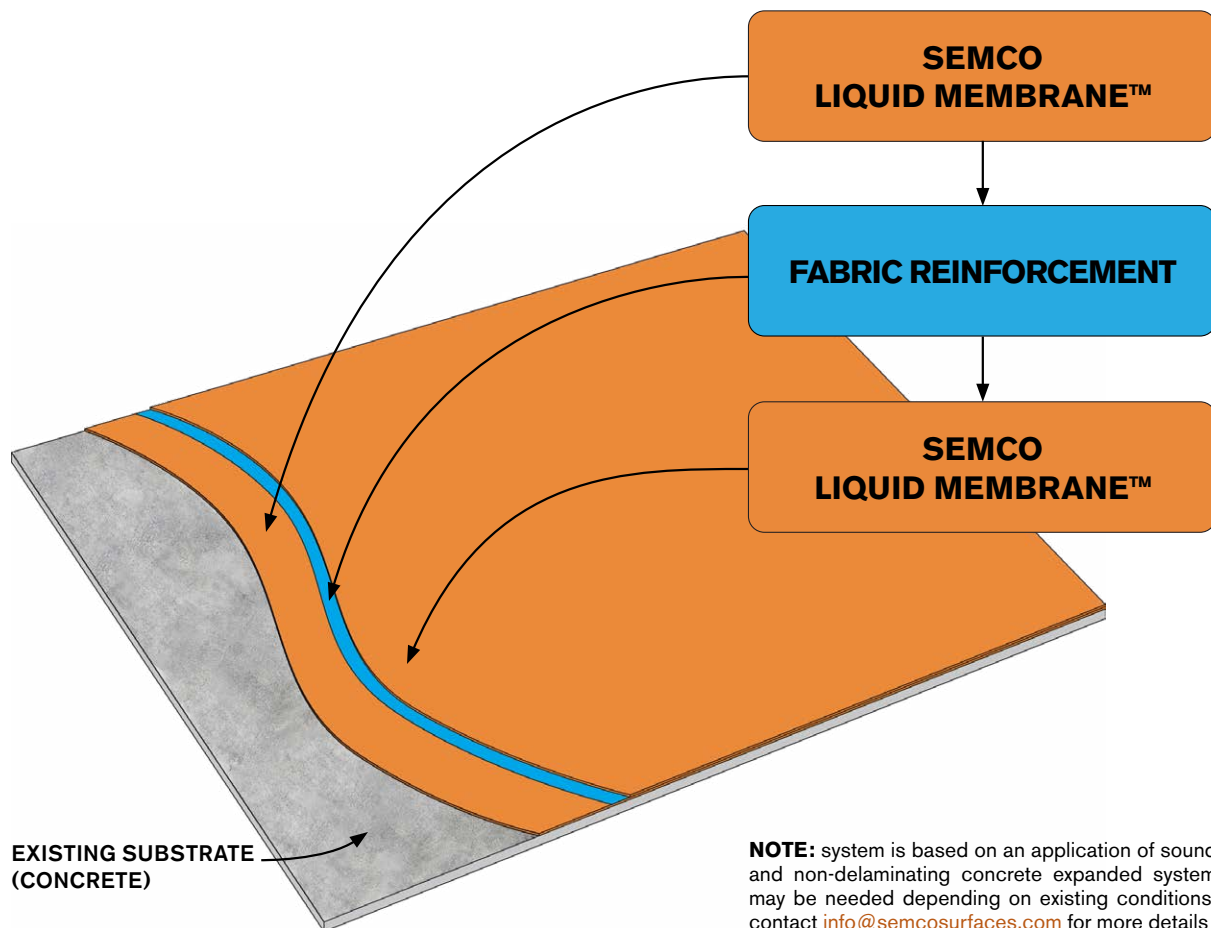

**NOTE:** system is based on an application of sound and non-delaminating concrete expanded system may be needed depending on existing conditions, contact [info@semcosurfaces.com](mailto:info@semcosurfaces.com) for more details



**FLOORS | WALLS | POOL DECKS | WATERPROOFING**  
REDEFINING THE ART OF SURFACE CREATIVITY FOR OVER 25 YEARS USING GREEN MATERIALS

